

**Application for Exemption under section 14A of the Private Columbaria Ordinance**  
**Summary of Application**  
**(For Publication Purpose)**

Information stated in this application summary is provided by the applicant and has not been verified by the Private Columbaria Licensing Board. It is the responsibility of the applicant to ensure that all the information contained in this application summary is entirely correct.

**(1) Basic information of the columbarium**

Name of the columbarium : Ching To Yuen

Address of the columbarium : 60 To Fung Shan Road, Shatin, New Territories, Hong Kong  
Lot No. 374(part) and Section A of Lot No. 375(part) in D.D. 186

Year of establishment : 2005

Name of operator : Ching To Yuen Limited

Status of operator : ~~\*land owner / current tenant of the premises~~ (under a lease / ~~tenancy~~ of  
 years from 26 Aug 2003 to 30 June 2047 )

**(2) Site information and building arrangement**

This columbarium has a site area of about 177 square meters and a total building floor area of about 177 square meters. It is composed of:

1 columbarium block(s);  
0 joss paper burner(s);  
0 refuse storage rooms;

Other buildings which are facilities necessary for or ancillary to the operation of the columbarium (please specify nature and number) NIL

Other facilities necessary for or ancillary to the operation of the columbarium (e.g.: parking facilities, loading and unloading facilities) (please specify nature, area and number) NIL

\* Delete where appropriate.

[illegible]

**PROPOSED SITE PLAN (PLAN NO. E-001) 1:500@A3**

Lot No.374(part) and Section A of Lot No. 375(part) in D.D.186

(4) **Proposed layout plan of the columbarium**

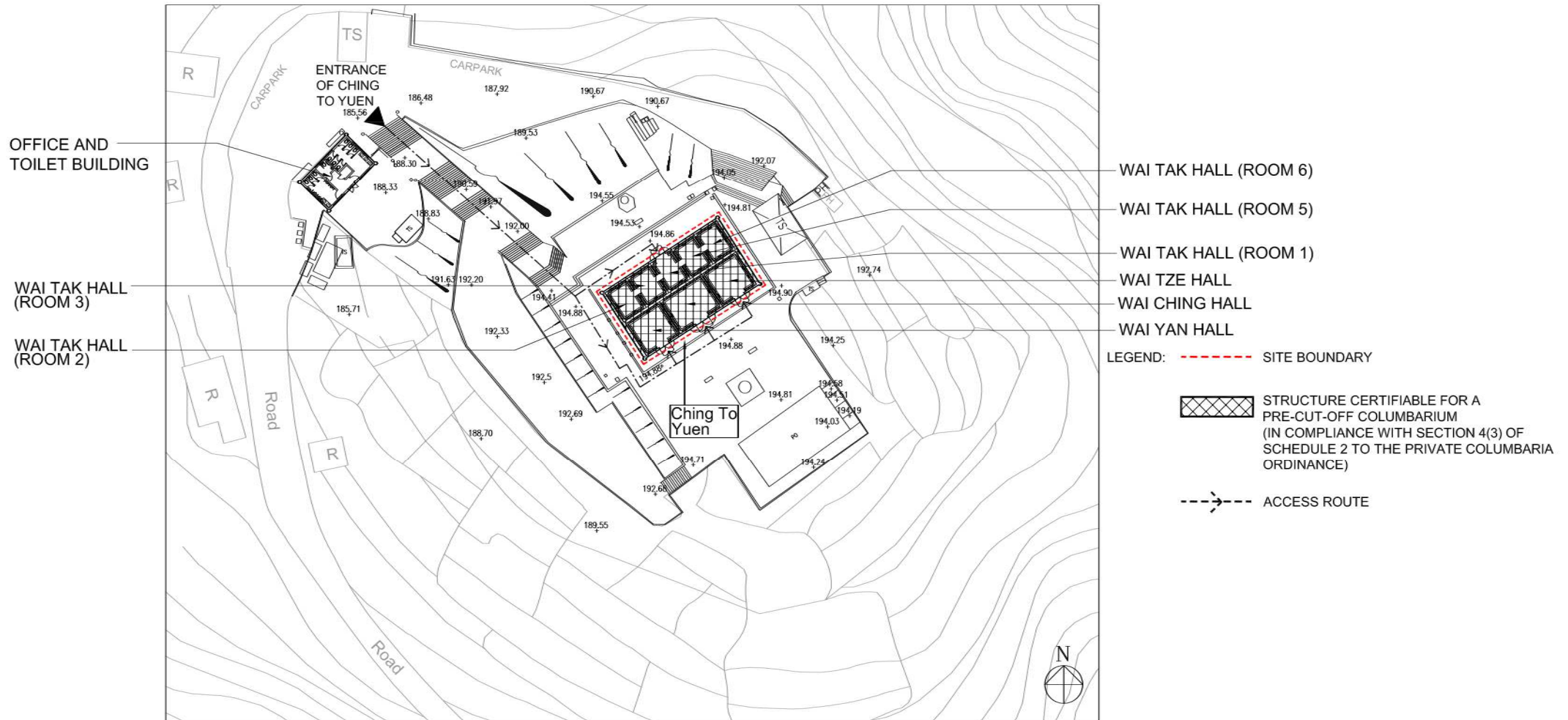

(DRAWN TO METRIC SCALE)

**PROPOSED LAYOUT PLAN (PLAN NO. E-002) 1:500@A3**

**Name of Columbarium:** Ching To Yuen

**Address:** 60 To Fung Shan Road, Shatin, N.T.

Lot No.374(part) and Section A of Lot No. 375(part) in D.D.186

|  |                   |
|--|-------------------|
| Ash interment quantity "to be permitted under Exemption"     | 3,602 Sets of ash |
| Ash interment quantity at the time of submitting application | 2,512 Sets of ash |