

Private Columbarium
Summary of Application for Temporary suspension of liability (TSOL)
(For Publication Purpose)

Information stated in this application summary is provided by the applicant and has not been verified by the Private Columbaria Licensing Board. It is the responsibility of the applicant to ensure that all the information contained in this application summary is entirely correct.

(1) Basic information of the columbarium

Name of the columbarium : Ten Thousand Buddhas Monastery

Address of the columbarium : No. 221 Pai Tau Village, Sha Tin, New Territories (Lot Nos. 324 (Part), 359 (Part) in DD 185 and adjoining government land)

Year of establishment : 1960

Name of operator : H.K. Ten Thousand Buddhas Monastery Management Committee Limited

Status of operator : *land owner / current tenant of the premises (under a lease/ tenancy of 10 years from 1.2.2018 to 31.1.2028)

(2) Site information and building arrangement

This columbarium has a site area of about 647.77 square meters and a total building floor area of about 515 square meters. It is composed of:

4 columbarium block(s);
2 joss paper burner(s);
0 refuse storage rooms;

Other buildings which are facilities necessary for or ancillary to the operation of the columbarium (please specify nature and number) N.A.

Other facilities necessary for or ancillary to the operation of the columbarium (e.g.: parking facilities, loading and unloading facilities) (please specify nature, area and number) N.A.

* Delete where appropriate.

(3) Proposed site plan of the columbarium

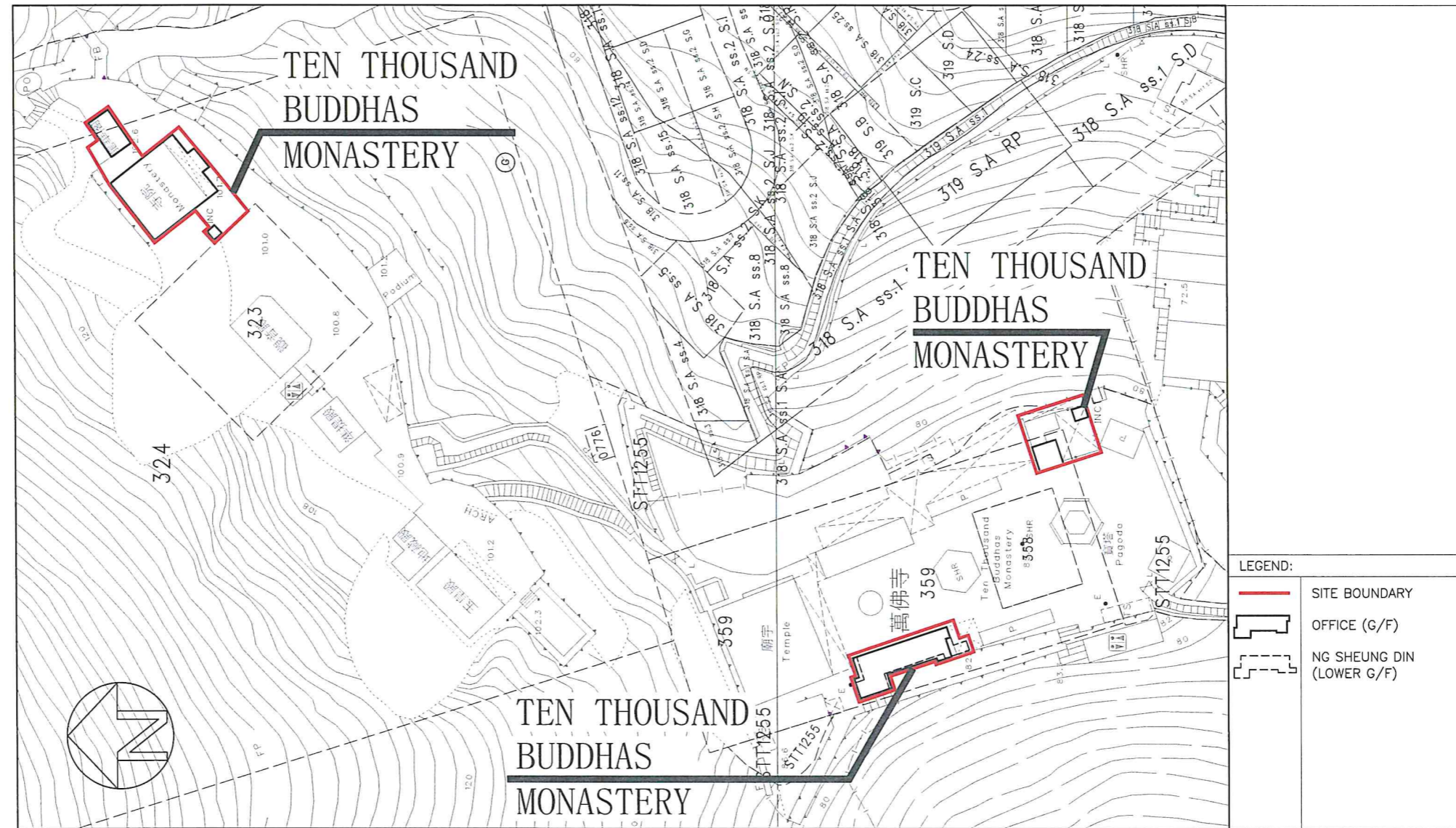

10 0 10 20 30 40 50 m 1 : 1000 © A3 SIZE

PROPOSED SITE PLAN (PLAN NO. SK01)

NAME OF COLUMBARIUM: TEN THOUSAND BUDDHAS MONASTERY

ADDRESS: NO. 221 PAI TAU VILLAGE, SHA TIN, NEW TERRITORIES (LOT NOS. 324 (PART), 359 (PART) IN DD 185 AND ADJOINING GOVERNMENT LAND)

(4) Proposed layout plan of the columbarium

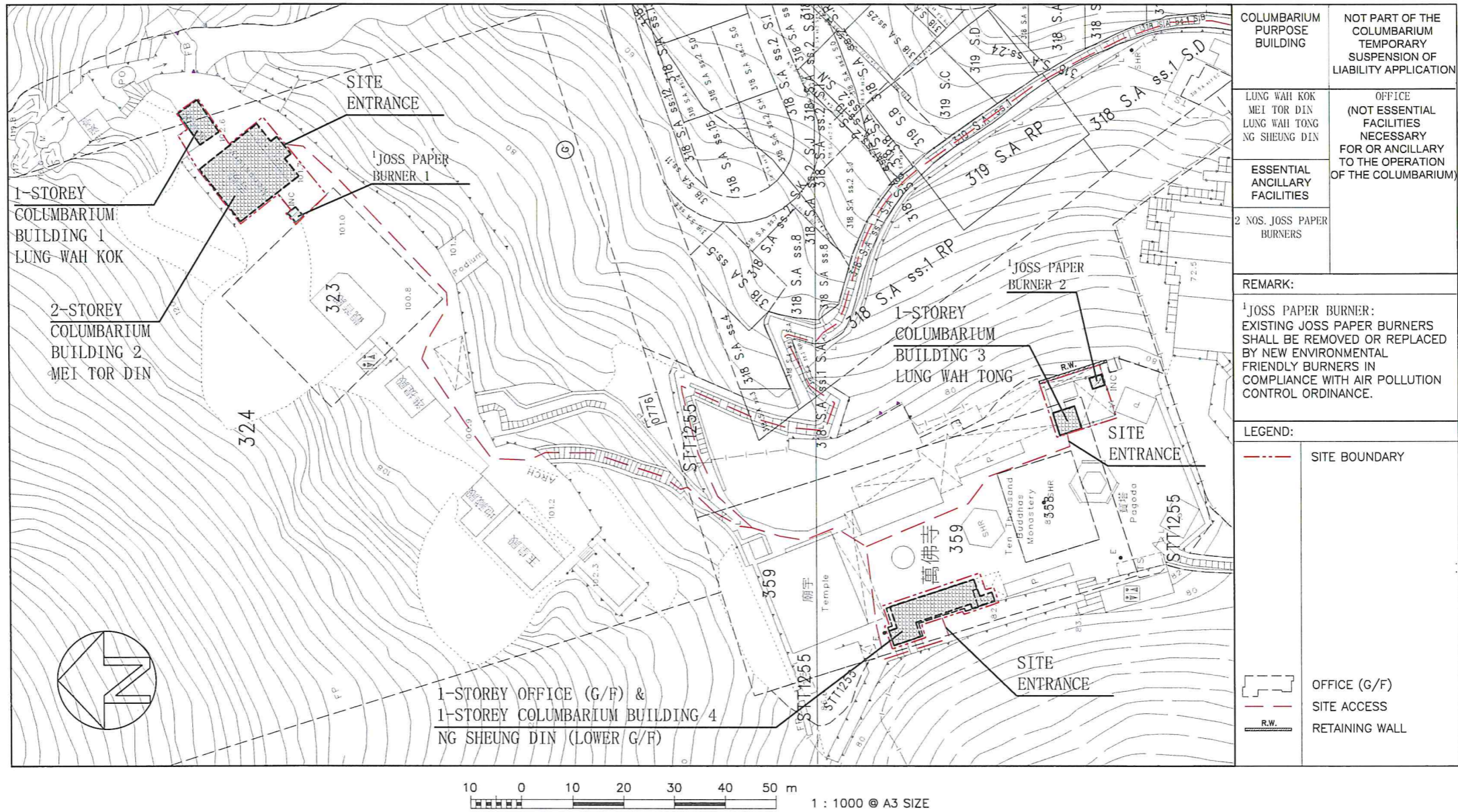

COLUMBARIUM PURPOSE BUILDING	NOT PART OF THE COLUMBARIUM TEMPORARY SUSPENSION OF LIABILITY APPLICATION
LUNG WAH KOK MEI TOR DIN LUNG WAH TONG NG SHEUNG DIN	OFFICE (NOT ESSENTIAL FACILITIES NECESSARY FOR OR ANCILLARY TO THE OPERATION OF THE COLUMBARIUM)
ESSENTIAL ANCILLARY FACILITIES	
2 NOS. JOSS PAPER BURNERS	
REMARK:	¹ JOSS PAPER BURNER: EXISTING JOSS PAPER BURNERS SHALL BE REMOVED OR REPLACED BY NEW ENVIRONMENTAL FRIENDLY BURNERS IN COMPLIANCE WITH AIR POLLUTION CONTROL ORDINANCE.
LEGEND:	
	SITE BOUNDARY
	SITE ACCESS
	RETAINING WALL
	OFFICE (G/F)

10 0 10 20 30 40 50 m 1 : 1000 @ A3 SIZE
PROPOSED LAYOUT PLAN (PLAN NO. SK02)

NAME OF COLUMBARIUM: TEN THOUSAND BUDDHAS MONASTERY
ADDRESS: NO. 221 PAI TAU VILLAGE, SHA TIN, NEW TERRITORIES (LOT NOS. 324 (PART), 359 (PART) IN DD 185 AND ADJOINING GOVERNMENT LAND)

Ash interment quantity "to be permitted under TSOL"	1533 sets of ash
Ash interment quantity at the time of submitting application	1533 sets of ash